

Franklyn James



Jessop Building, Dominion Walk

Canary Wharf, London, E14 9FN

Asking Price £450,000

CHAIN FREE -Franklyn James are proud to present this two double bedroom apartment in this newly built sought-after Ballymore development. This bright apartment is situated on the ninth floor and comprises of two spacious double bedrooms, an expansive open plan living kitchen area with fully equipped integrated appliances and four-piece family bathroom suite.

Further benefits include on-site 24-hour security, floor to ceiling windows, large private balcony, and secure underground bike storage. Jessop Building is set in a family-friendly and residential area with a real community feel, this property is within walking distance of Blackwall station for DLR access as well as Canary Wharf Station for Jubilee Line access and Crossrail for an easy commute to the City and Heathrow Airport. The property is surrounded by the banks of River Thames for lovely evening strolls or morning runs and with Canary Wharf set within walking distance, you can find a collection of bars, restaurants and local amenities all on your doorstep.

- Two double bedrooms
- One bathroom
- Spacious open plan living kitchen area
- Large private balcony
- Secure bike storage
- 24-hour on-site security
- Great transport links

Viewing

Please contact our Westferry Sales Office on 02070056080 if you wish to arrange a viewing appointment for this property or require further information.



Floor Plan

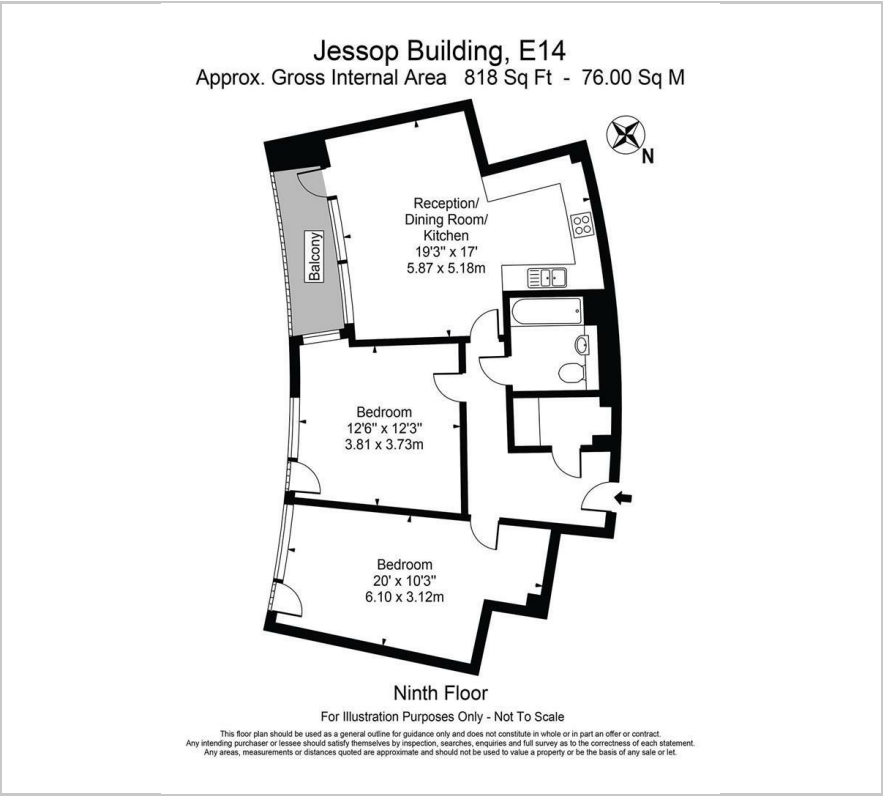

Area Map



Energy Efficiency Graph



These particulars, whilst believed to be accurate are set out as a general outline only for guidance and do not constitute any part of an offer or contract. Intending purchasers should not rely on them as statements of representation of fact, but must satisfy themselves by inspection or otherwise as to their accuracy. No person in this firm's employment has the authority to make or give any representation or warranty in respect of the property.